

THERMAL **CORPORATION**

A Division of Nailor International Inc.



MODEL RX : ENERGY RECOVERY AIR HANDLING UNITS

3,000 - 30,000 CFM AHU

Contents

	Page No.
Product Overview	1
Rotary Wheel Energy Recovery AHU - Specs and Dims	2
Plate Fin Heat Recovery AHU - Specs and Dims	3

ENERGY RECOVERY AIR HANDLING UNITS

PRODUCT OVERVIEW

Thermal Corporation's Model RX (Energy Recovery) air handlers are designed with quality in mind. They have the flexibility to be designed as a Classic Welded Frame, T-Series, F-Series, or even the TS-Series. Thermal Corporation's Model RX can also be equipped with virtually any type of heat exchanger from heat pipes, to rotary wheels, to plate fin heat exchangers. We take pride in providing long lasting, quality air handling units, and the Model RX is no exception.

ENERGY RECOVERY CUSTOM AIR HANDLING UNITS

MODELS:

RX	Classic Welded Frame, Model RX
TRX	T-Series, Model RX
FRX	F-Series, Model RX
TSRX	TS-Series, Model RX

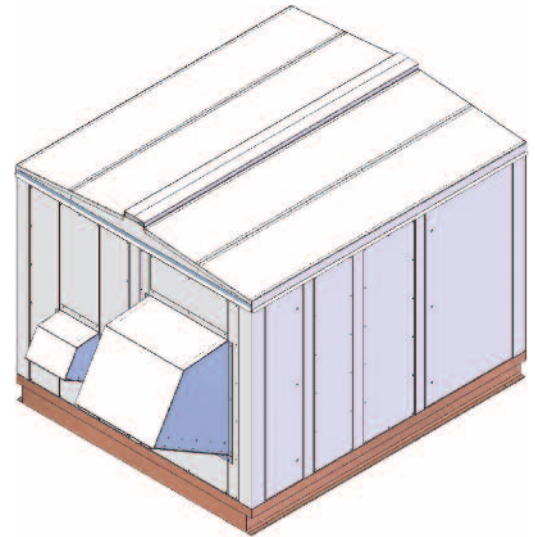

Construction Features:

- Any of our four construction types are available.
- 2", 3", or 4" thick walls with single or double wall construction (TSRX is only available in 2 3/8" double wall construction).
- Structural steel fan bases are internally spring-isolated.
- AMCA-rated forward-curved (DWDI), housed airfoil (DWDI), or plenum fans (SWSI) are available.
- Full walk-on floor of galvanized steel.
- AHRI certified coils in 1/2" or 5/8" O.D. copper tubes. 1" O.D. steam distributing coils are also available upon request.
- Each unit is provided with louvered rainhoods with birdscreens, and optional bug screen.
- Weatherproof construction coated with our standard light grey, air-dried epoxy paint.

Design Flexibility:

- Units can be provided with rotary wheels, plate fin heat exchangers, or heatpipes.
- Units are customized to your particular application.
- Any unit size available up to 30,000 CFM on standard units and up to 100,000 CFM and beyond on custom units,
- Units can be designed for indoor or outdoor applications.
- Special third-party vendor items such as humidifiers, blenders, evaporative coolers, and IFB coils can be factory mounted.
- Units can be designed with multiple fans for low profile cabinets or redundant operation.
- Full selection of air filters to meet indoor air quality standards.
- Outdoor units can be provided with roof curbs.

ROTARY WHEEL ENERGY RECOVERY AHU - SPECS AND DIMS

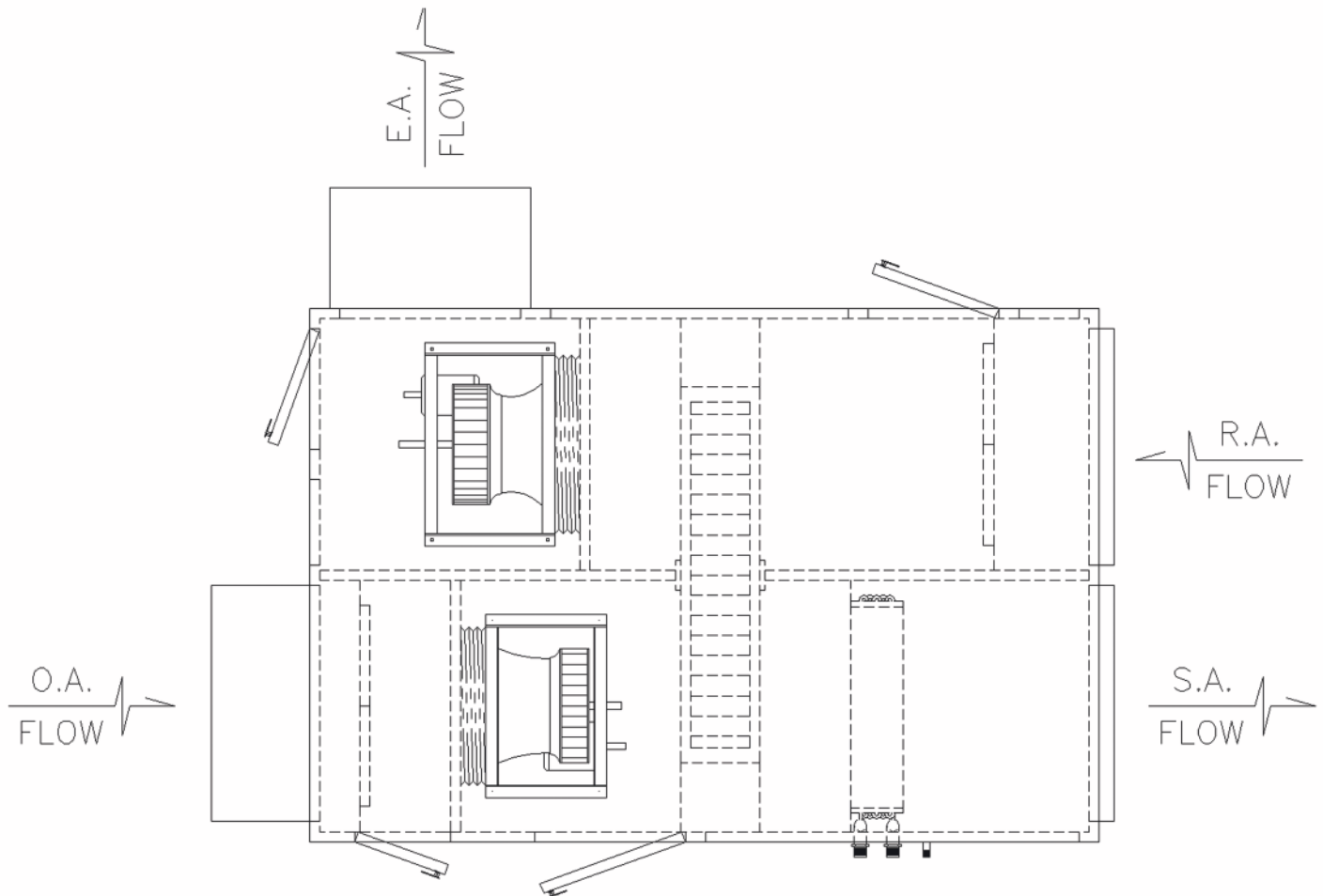

THERMAL MODEL RX-		40	50	60	80	100	130	160	190	230	280
Nominal Air Flow Rate, CFM		4000	5000	6000	8000	10000	13000	16000	19000	23000	28000
CFM @ Velocity Through Wheel	500 FPM	3040	3840	4760	6100	7630	9760	12180	14830	17780	21650
	600 FPM	3650	4610	5720	7320	9150	11710	14610	17800	21340	25980
	700 FPM	4250	5380	6670	8540	10680	13660	17050	20770	24900	30310
Casing Dimensions (inches)	Length	132	162	162	168	168	174	174	192	192	228
	Width	76	80	88	102	106	112	120	126	140	148
	Height	68	72	76	84	92	104	112	124	132	142
Fan and Motor Information	Fan Size	16"	18"	20"	24"	27"	30"	33"	36"	40"	44"
	Std. HP	5	5	5	7.5	10	15	15	15	20	25
	Max HP	7.5	10	10	15	15	20	25	30	40	40
Filters (Size and Quantity)	16 x 20	—	—	8	—	12	6	5	4	24	6
	16 x 25	2	2	—	—	—	6	—	2	—	12
	20 x 20	—	—	—	—	—	—	10	8	—	2
	20 x 25	2	2	—	6	—	—	—	4	—	4
	Total F.A.	12.50	12.50	17.78	20.83	26.67	30.00	38.89	50.56	53.33	66.11
Optional Coils (Size and Quantity)	Coils / Bank	2	2	2	2	2	3	3	3	3	3
	Tube Face	16	18	18	22	24	18	20	22	24	26
	Finned Length	28	30	34	41	43	46	50	53	60	64
	Total F.A.	9.63	11.56	13.10	19.22	21.95	26.59	32.03	37.27	45.94	53.00

*Based on 2" Classic Welded Frame Construction with a 5" channel base.

PLATE FIN HEAT RECOVERY AHU - SPECS AND DIMS

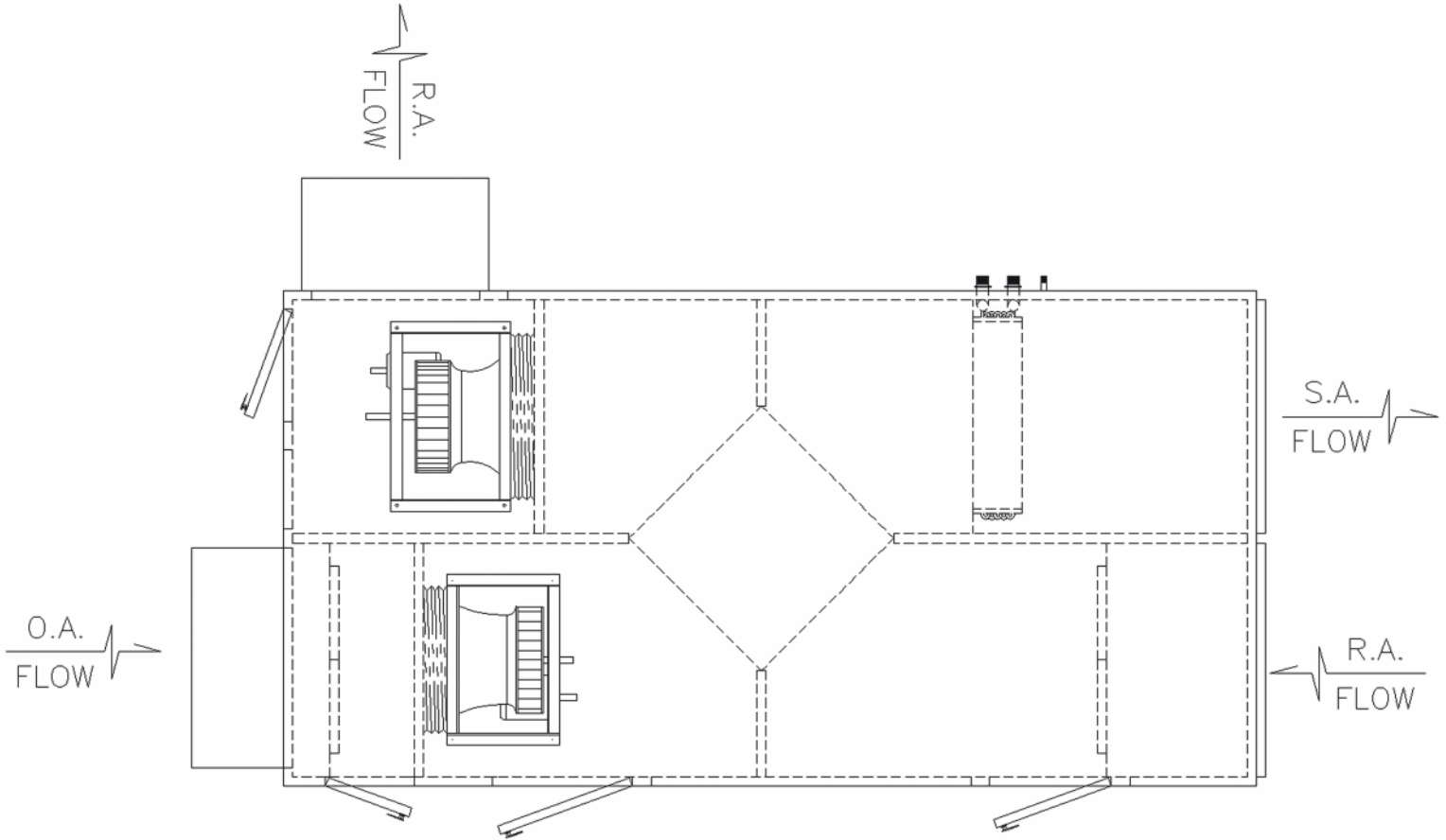

THERMAL MODEL RX-		40	50	60	80	100	130	160	190	230	280
Nominal Air Flow Rate, CFM		4000	5000	6000	8000	10000	13000	16000	19000	23000	28000
CFM @ Velocity Through Wheel	500 FPM	3040	3840	4760	6100	7630	9760	12180	14830	17780	21650
	600 FPM	3650	4610	5720	7320	9150	11710	14610	17800	21340	25980
	700 FPM	4250	5380	6670	8540	10680	13660	17050	20770	24900	30310
Casing Dimensions (inches)	Length	172	202	202	208	208	214	214	232	232	268
	Width	76	80	88	102	106	112	120	126	140	148
	Height	68	72	76	84	92	104	112	124	132	142
Fan and Motor Information	Fan Size	16"	18"	20"	24"	27"	30"	33"	36"	40"	44"
	Std. HP	5	5	5	7.5	10	15	15	15	20	25
	Max HP	7.5	10	10	15	15	20	25	30	40	40
Filters (Size and Quantity)	16 x 20	—	—	8	—	12	6	5	4	24	6
	16 x 25	2	2	—	—	—	6	—	2	—	12
	20 x 20	—	—	—	—	—	—	10	8	—	2
	20 x 25	2	2	—	6	—	—	—	4	—	4
	Total F.A.	12.50	12.50	17.78	20.83	26.67	30.00	38.89	50.56	53.33	66.11
Optional Coils (Size and Quantity)	Coils / Bank	2	2	2	2	2	3	3	3	3	3
	Tube Face	16	18	18	22	24	18	20	22	24	26
	Finned Length	28	30	34	41	43	46	50	53	60	64
	Total F.A.	9.63	11.56	13.10	19.22	21.95	26.59	32.03	37.27	45.94	53.00

*Based on 2" Classic Welded Frame Construction with a 5" channel base.



4714 Winfield Road Houston, TX 77039

Tel: 281-590-1172 • 281-897-9000

Fax: 281-897-9007

www.thermal-corp.com

06-20-11